

PROJECT: Planting on US 158 (Clemmons Road) at the Yadkin River from Bermuda Run Drive to Craver Land Road

PROPOSED HIGHWAY LANDSCAPE DEVELOPMENT PROJECT

T.I.P. #	STATE PROJECT W.B.S. #	SHEET #	SHEET # TOTAL
		1	7
DESCRIPTION			DIVISION
Planting on US 158 at Yadkin River			9

Summary of Quantities

Plant Materials							
Quan.	Key	Unit	Botanical Name	Common Name	furnish	ASNS	Spacing
Shade Trees							
9	AR	EA	<i>Acer rubrum</i>	Red Maple	1 1/2 - 2" Cal., B&B	1.2.1	As Shown
9	QN	EA	<i>Quercus nuttallii</i>	Nuttall Oak	2 1/2 - 3" Cal., B&B	1.2.1	50' OC
Ornamental Trees							
15	CAR	EA	<i>Cercos canadensis 'Appalachain Red'</i>	Appalachain Red Redbud	4-5', B&B or Cont.	1.2.3	As Shown
37	CFP	EA	<i>Cercis canadensis 'Forest Pansy'</i>	Forest Pansy Redbud	2-2 1/2" Cal., B&B, Sgl. Straight Trunk, Heavily Branched, Matched specimens	1.2.3	As Shown (20' OC)
29	CVP	EA	<i>Chionanthus virginicus 'Prodigy'</i>	Fringetree	2-2 1/2" Cal., B&B, Sgl. Straight Trunk, Heavily Branched, Matched specimens	1.2.4	As Shown (20' OC)
16	CCP	EA	<i>Cornus florida 'Cherokee Princess'</i>	Cherokee Princess Dogwood	4-5', B&B or Cont.	1.2.4	As Shown
33	CR	EA	<i>Cornus x 'Rutban'</i>	Aurora Dogwood	2-2 1/2" Cal., B&B, Sgl. Straight Trunk, Heavily Branched, Matched specimens	1.2.3	As Shown (20' OC)
Broadleaf Evergreen and Conifer Trees							
13	CJY	EA	<i>Cryptomeria japonica 'Yoshino'</i>	Yoshino Japanese Cedar	6-7', B&B, Full to Ground	3.2.6	As Shown
19	IOG	EA	<i>Ilex opaca 'Greenleaf'</i>	Greenleaf Holly	4-5', B&B, Heavy, Limbed to ground	4.2.5	As Shown
5	MLG	EA	<i>Magnolia grandiflora 'Little Gem'</i>	Little Gem Magnolia	7-8', B&B, Heavy, Limbed to ground	1.2.2	As Shown
20	TGG	EA	<i>Thuja plicata 'Green Giant'</i>	Green Giant Arborvitae	6-7', B&B, Full to Ground	3.2.6	As Shown
Shrubs							
21	IG	EA	<i>Ilex glabra</i>	Inkberry	18-24", #3 Cont.	4.2.4	As Shown
Grasses							
513	CL	EA	<i>Chasmanthium latifolia</i>	River Oats	#1 Cont.		2' OC
1181	MC	EA	<i>Muhlenbergia capillaris</i>	Pink Muhly Grass	#1 Cont.		3' OC
Other Items							
255		CY	Mulch for Planting	Double Shredded Hardwood			

Vicinity Map

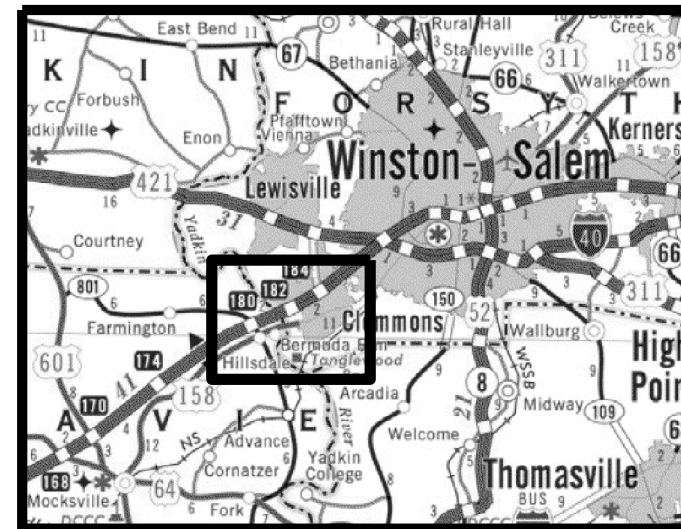

CONVENTIONAL SYMBOLS

County Line	-----
City or Town Line	-----
Exist. Right of Way Line Marker	-----▲-----
Prop. Right of Way Line Marker (By Other)	-----▲-----
Prop Right of Way Line Marker (By Contract)	-----▲-----
Exist. Control of Access Line	-----⊕-----
Prop. Control of Access Line	-----⊕-----
Property Line	-----
Easement Line	-----
Slope Stake Line	-----
Exist. Fence	-----
Prop. Woven Wire Fence	-----
Prop. Chain Link Fence	-----
Exist. Road	-----
Prop. Road	-----
Guardrail	-----
Survey Line	-----
Denotes Line Equality	-----
Bridge	-----
Culvert	-----
Railroad	-----
Woods	-----
Exist. Telephone Pole	-----
Prop. Telephone Pole	-----
Tower Pole and Line	-----
Exist. Power Pole	-----
Prop. Power Pole	-----
Sanitary Sewer Line	-----
Water Line	-----
Gas Line	-----
Picnic Shelter	-----
Regeneration	-----
Reforestation	-----

INDEX OF L SHEETS:

- 1..... Title, Description and Summary of Quantities
- 2..... Details
- 3-9..... Planting Plans

PREPARED BY:	CSM
PRELIMINARY DESIGN DATE:	June 8, 2012
REVISION DATE:	July 27, 2012
FINAL DESIGN DATE:	July 27, 2012
2004 American Standard for Nursery Stock 2012 NCDOT STANDARD SPECIFICATIONS	
HIGHWAY DIVISION 9 375 Silas Creek Pkwy, Winston Salem, NC 27127 Division Eng. - S.P. Ivey, PE (336)703-6500 Roadside Environmental Department RE Office Eng. - Todd Hiatt (336)896-7019	
PLANS PREPARED IN THE OFFICE OF: NCDOT- ROADSIDE ENVIRONMENTAL UNIT Landscape Design & Development Section 1557 Mail Service Center Raleigh NC 27699 919-707-2920	



STATE OF
NORTH CAROLINA
DEPARTMENT OF TRANSPORTATION

LOCATION:	US 158 at the Yadkin River
TYPE of WORK:	Planting
COUNTY:	Forsyth County

SHEET
1
of
7

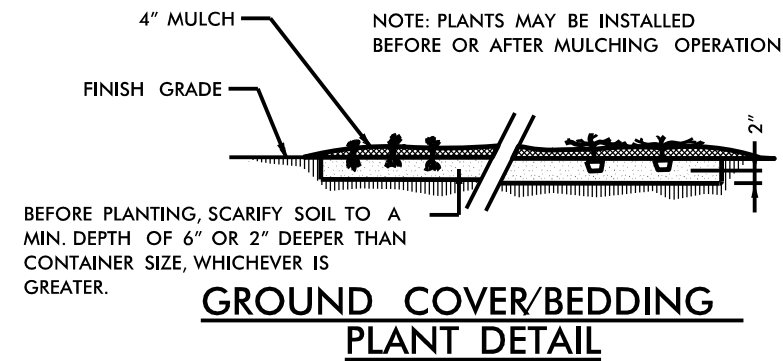
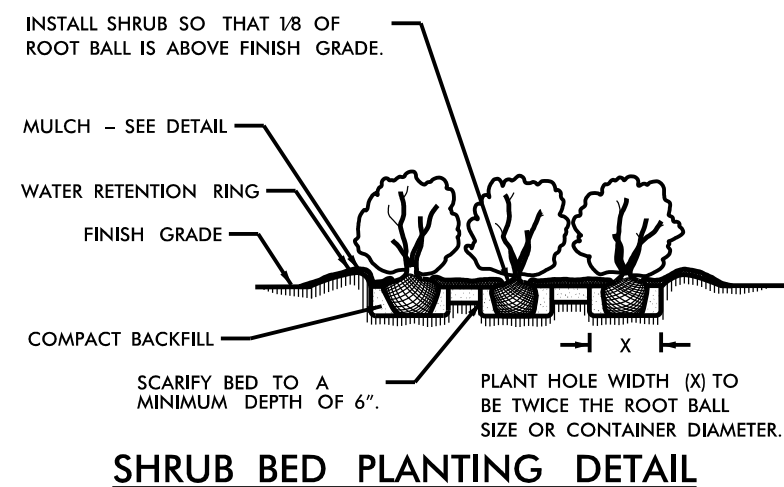
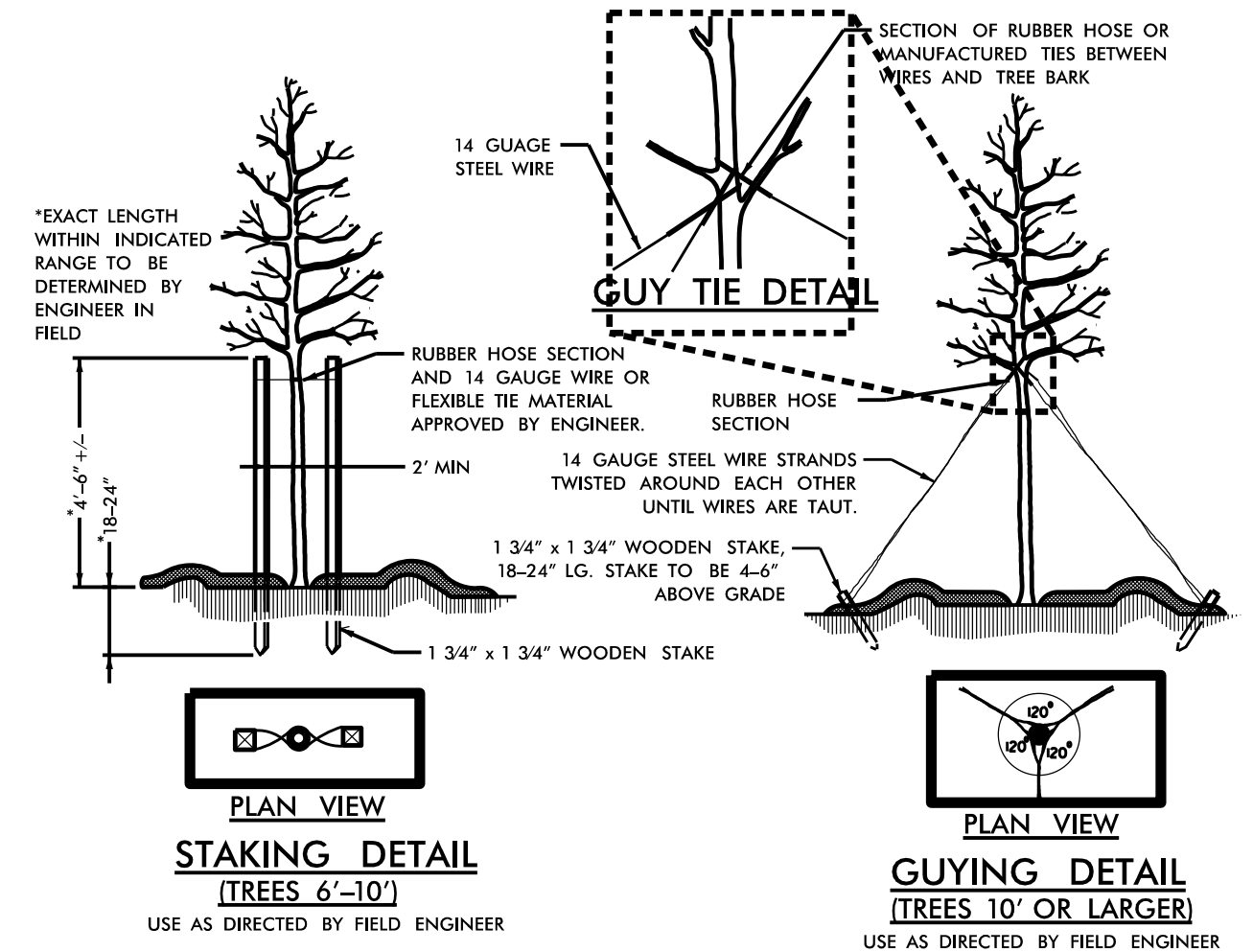
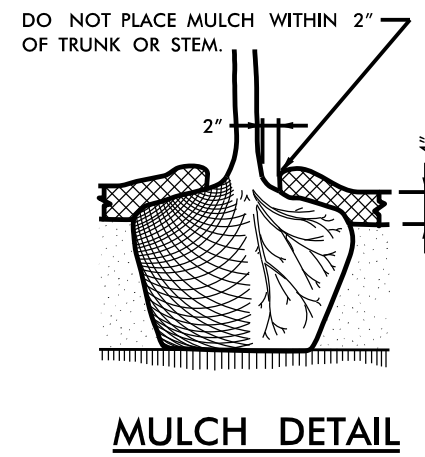
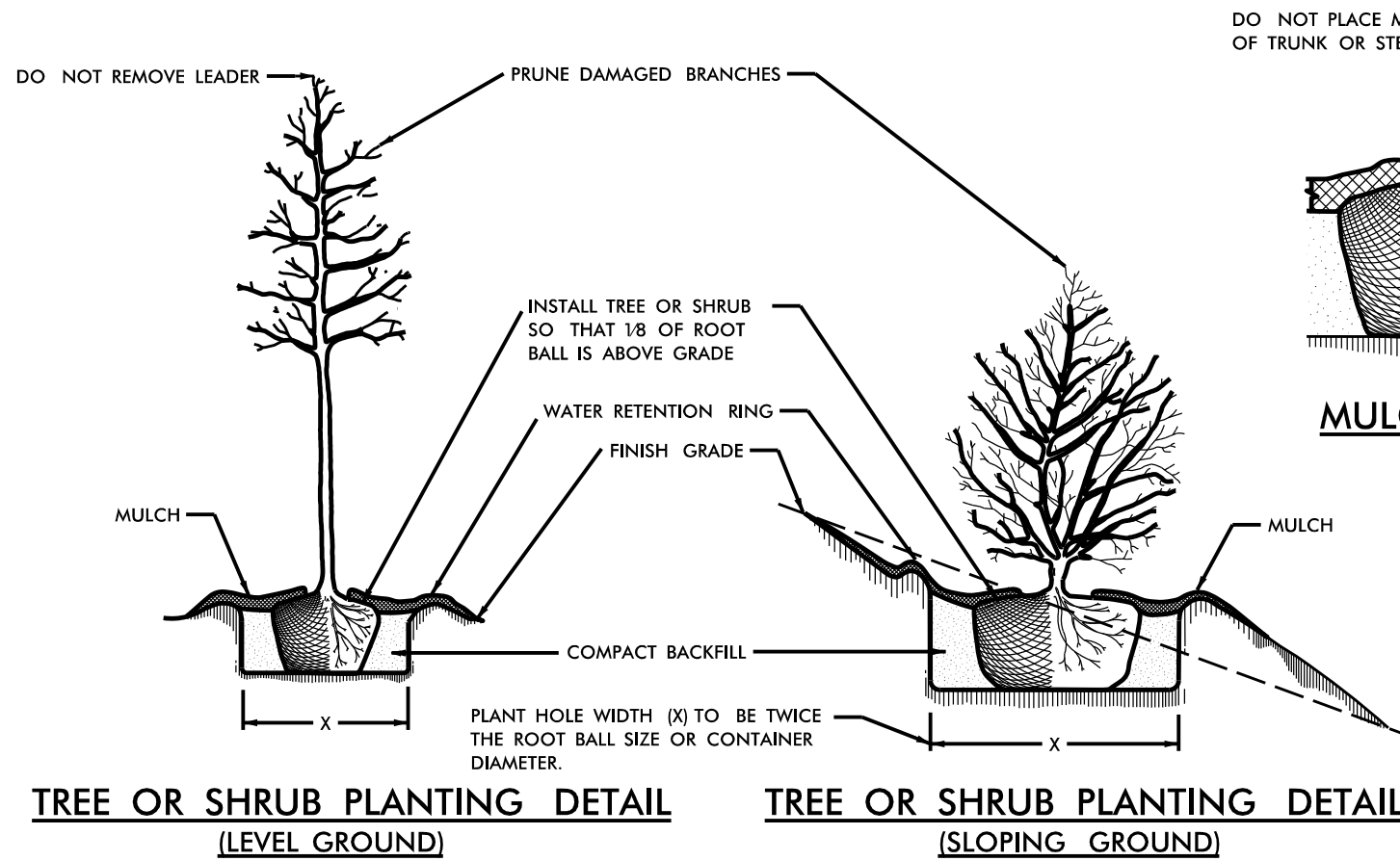

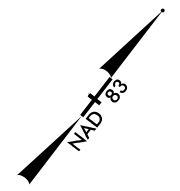
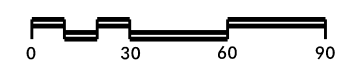
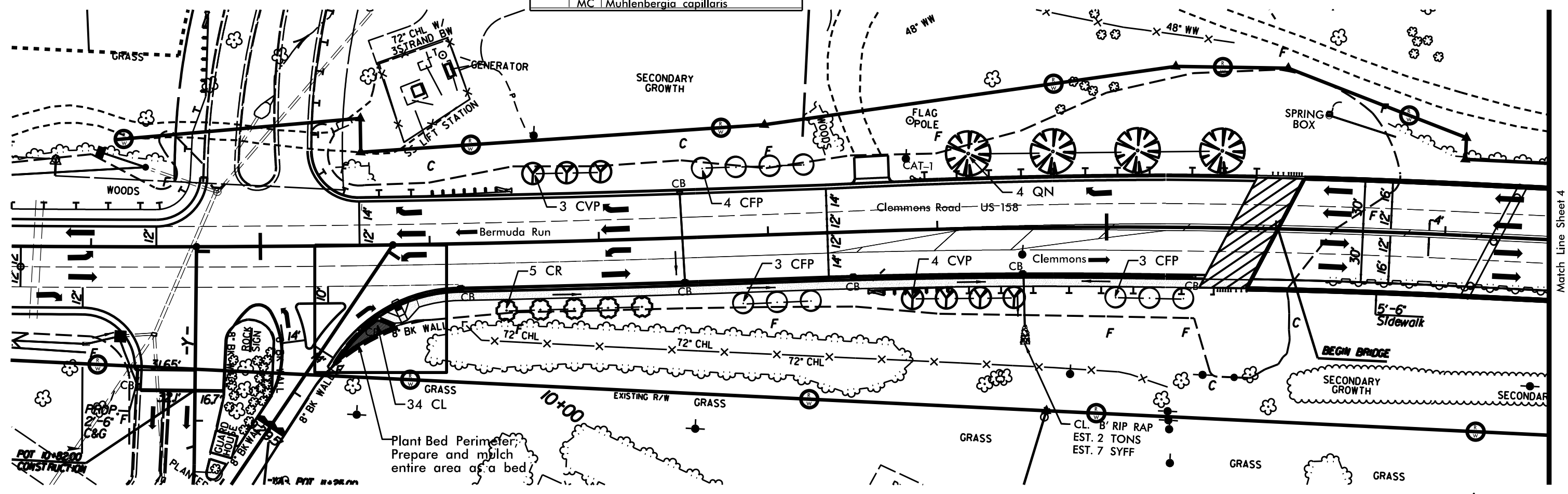

- NOTES:**
- SCHEDULE FOR PLANT HOLE SIZE: PLANT HOLE WIDTH (X) TO BE TWICE THE ROOT BALL SIZE OR CONTAINER DIAMETER.
 - SEE STANDARD SPECIFICATIONS FOR PLANT BED FUMIGATION AND HERBICIDAL TREATMENT.
 - APPLY FERTILIZER AT PLANTING TIME IN THE FORM OF A SLOW RELEASE PELLET OR TABLET. APPLY AT RATE RECOMMENDED BY MANUFACTURER. BOTH RATE AND FORMULATION MUST BE APPROVED BY FIELD ENGINEER PRIOR TO APPLICATION.
 - REMOVE WIRE BASKET AND FOLD BURLAP BACK FROM TOP OF ROOT BALL BEFORE BACKFILLING IS COMPLETE.
 - ALL PRUNING TO FOLLOW STANDARD ARBORICULTURAL PRACTICES AS SPECIFIED BY INTERNATIONAL SOCIETY OF ARBORICULTURE.
 - DO NOT ATTEMPT TO STRAIGHTEN A TREE THAT HAS BEEN PLANTED AT AN ANGLE WITH THE USE OF STAKING OR GUYING. DIG TREE AND REPLANT TO UPRIGHT POSITION.

Plant List		
Quan.	Key	Botanical Name
Shade Tree		
	AR	Acer rubrum
4	QN	Quercus nuttallii
Ornamental Tree		
	CAR	Cercis canadensis 'Appalachian Red'
10	CFP	Cercis canadensis 'Forest Pansy'
7	CVP	Chionanthus virginicus 'Prodigy'
	CCP	Cornus florida 'Cherokee Princess'
5	CR	Cornus x 'Rutban'
Broadleaf Evergreen & Conifer Trees		
	CJY	Cryptomeria japonica 'Yoshino'
	IOG	Ilex opaca 'Greenleaf'
	MLG	Magnolia grandiflora 'Little Gem'
	TGG	Thuja plicata 'Green Giant'
Shrubs		
	IG	Ilex glabra
Grasses		
34	CL	Chasmanthium latifolia
	MC	Muhlenbergia capillaris



NCDOT - Roadside Environmental Unit
Landscape Design & Development
 1557 Mail Service Center Raleigh NC 27699-1557
 ph: 919-707-2938
http://www.ncdot.org/doh/operations/dp_chief_eng/roadside/

US 158 (Clemmons Road) at the Yadkin River
From Bermuda Run Country Club Entrance to Craver Land Road
 TIP #:

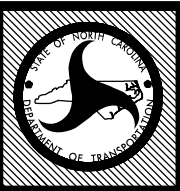



PREL. DESIGN DATE: June 8, 2012
 FINAL DESIGN DATE: July 27, 2012
 DIVISION & COUNTY:
Division 9, Forsyth County

Landscape Development
 Planting Plan

SHEET NO: 3
 TOTAL SHEET NO: 7

Match Line Sheet 4

Plant List		
Quan.	Key	Botanical Name
Shade Tree		
	AR	Acer rubrum
	QN	Quercus nuttallii
Ornamental Tree		
	CAR	Cercis canadensis 'Appalachian Red'
	CFP	Cercis canadensis 'Forest Pansy'
	CVP	Chionanthus virginicus 'Prodigy'
	CCP	Cornus florida 'Cherokee Princess'
	CR	Cornus x 'Rutban'
Broadleaf Evergreen & Conifer Trees		
	CJY	Cryptomeria japonica 'Yoshino'
	IOG	Ilex opaca 'Greenleaf'
	MLG	Magnolia grandiflora 'Little Gem'
	TGG	Thuja plicata 'Green Giant'
Shrubs		
	IG	Ilex glabra
Grasses		
	CL	Chasmanthium latifolia
	MC	Muhlenbergia capillaris

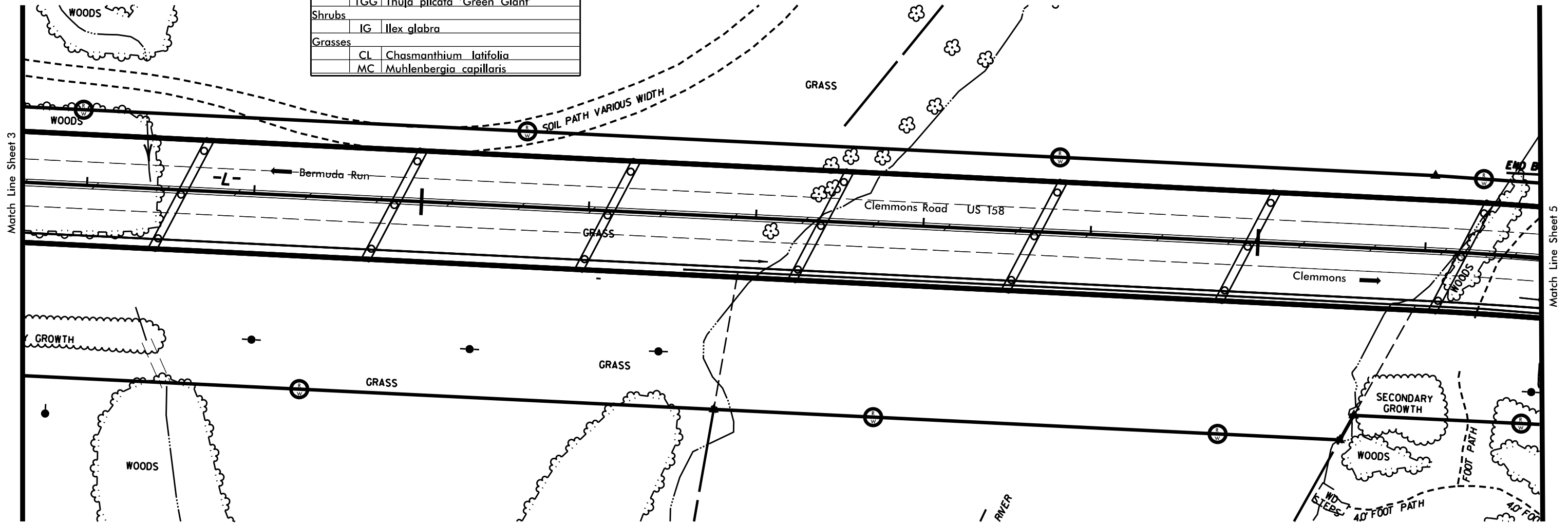

* No Planting This Sheet

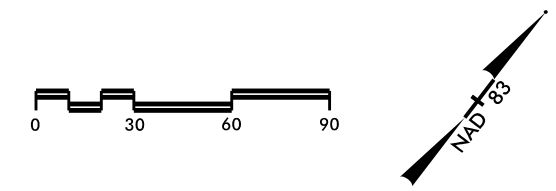

NCDOT - Roadside Environmental Unit
Landscape Design & Development
 1557 Mail Service Center Raleigh NC 27699-1557
 ph: 919-707-2938
http://www.ncdot.org/doh/operations/dp_chief_eng/roadside/

US 158 (Clemmons Road) at the Yadkin River
From Bermuda Run Country Club Entrance to Craver Land Road

TIP #:

Connie Morgan
 REU Engineer

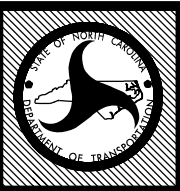

PREL. DESIGN DATE: June 8, 2012
 FINAL DESIGN DATE: July 27, 2012
 DIVISION & COUNTY: Division 9, Forsyth County

Landscape Development

Planting Plan

SHEET NO: 4
 TOTAL SHEET NO: 7

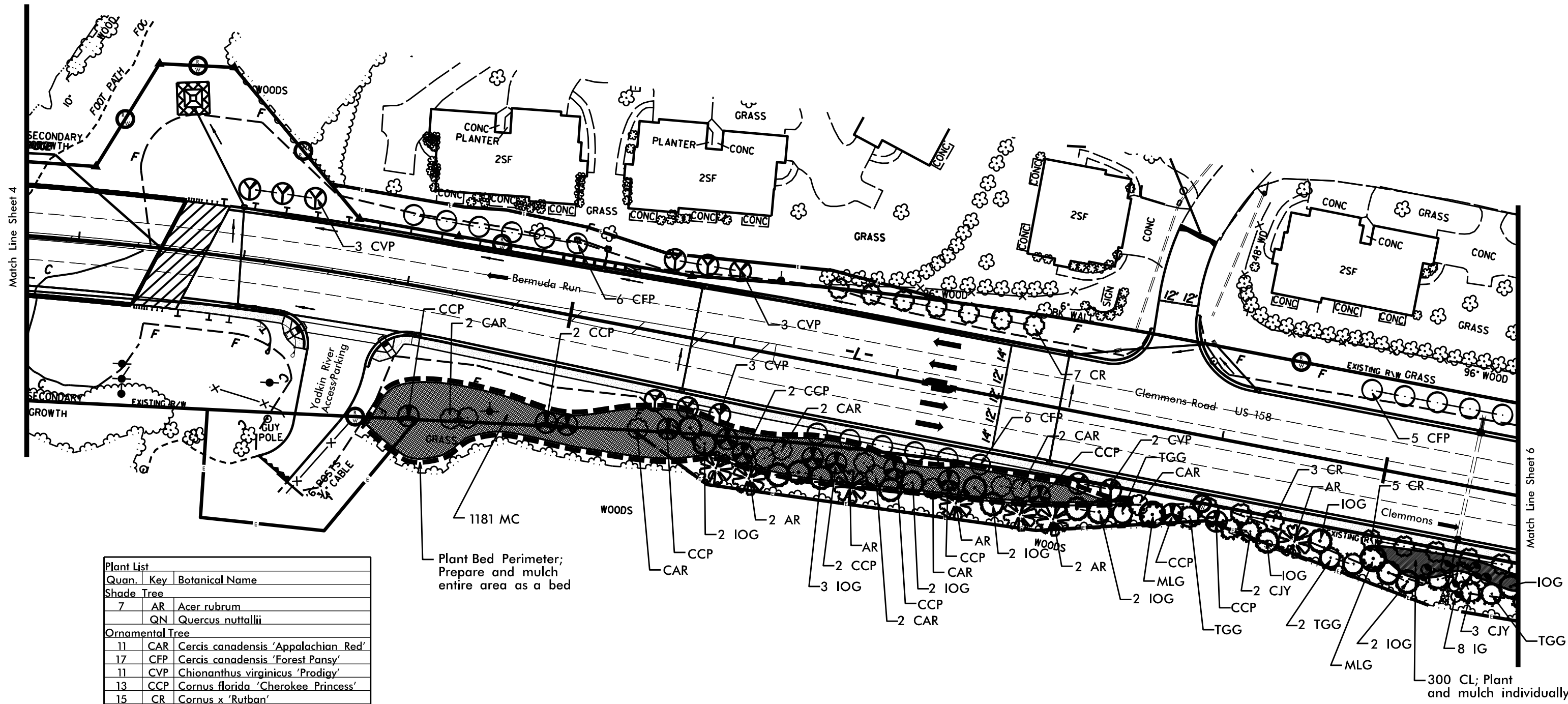

Quan.	Key	Botanical Name
Plant List		
Shade Tree		
7	AR	Acer rubrum
	QN	Quercus nuttallii
Ornamental Tree		
11	CAR	Cercis canadensis 'Appalachian Red'
17	CFP	Cercis canadensis 'Forest Pansy'
11	CVP	Chionanthus virginicus 'Prodigy'
13	CCP	Cornus florida 'Cherokee Princess'
15	CR	Cornus x 'Rutban'
Broadleaf Evergreen & Conifer Trees		
5	CJY	Cryptomeria japonica 'Yoshino'
16	IOG	Ilex opaca 'Greenleaf'
2	MLG	Magnolia grandiflora 'Little Gem'
5	TGG	Thuja plicata 'Green Giant'
Shrubs		
8	IG	Ilex glabra
Grasses		
300	CL	Chasmanthium latifolia
1181	MC	Muhlenbergia capillaris

Plant Bed Perimeter;
Prepare and mulch
entire area as a bed

300 CL; Plant
and mulch individually

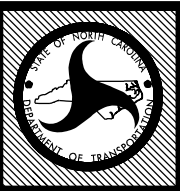

Plant List		
Quan.	Key	Botanical Name
Shade Tree		
2	AR	Acer rubrum
	QN	Quercus nuttallii
Ornamental Tree		
4	CAR	Cercis canadensis 'Appalachian Red'
9	CFP	Cercis canadensis 'Forest Pansy'
11	CVP	Chionanthus virginicus 'Prodigy'
3	CCP	Cornus florida 'Cherokee Princess'
13	CR	Cornus x 'Rutban'
Broadleaf Evergreen & Conifer Trees		
8	CJY	Cryptomeria japonica 'Yoshino'
3	IOG	Ilex opaca 'Greenleaf'
3	MLG	Magnolia grandiflora 'Little Gem'
15	TGG	Thuja plicata 'Green Giant'
Shrubs		
13	IG	Ilex glabra
Grasses		
179	CL	Chasmanthium latifolia
	MC	Muhlenbergia capillaris

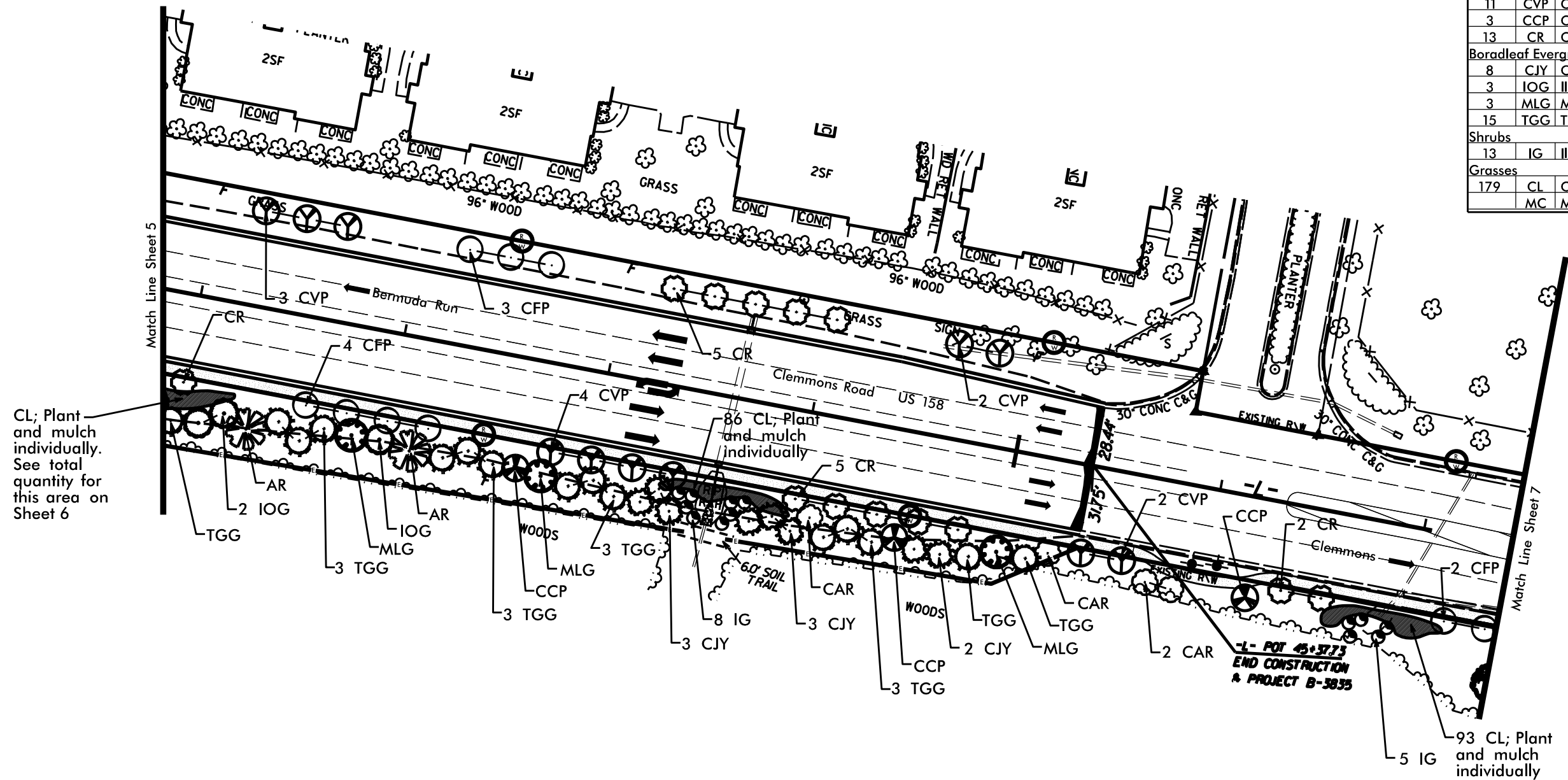

CL; Plant and mulch individually. See total quantity for this area on Sheet 6

93 CL; Plant and mulch individually

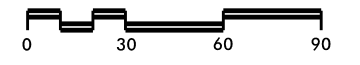

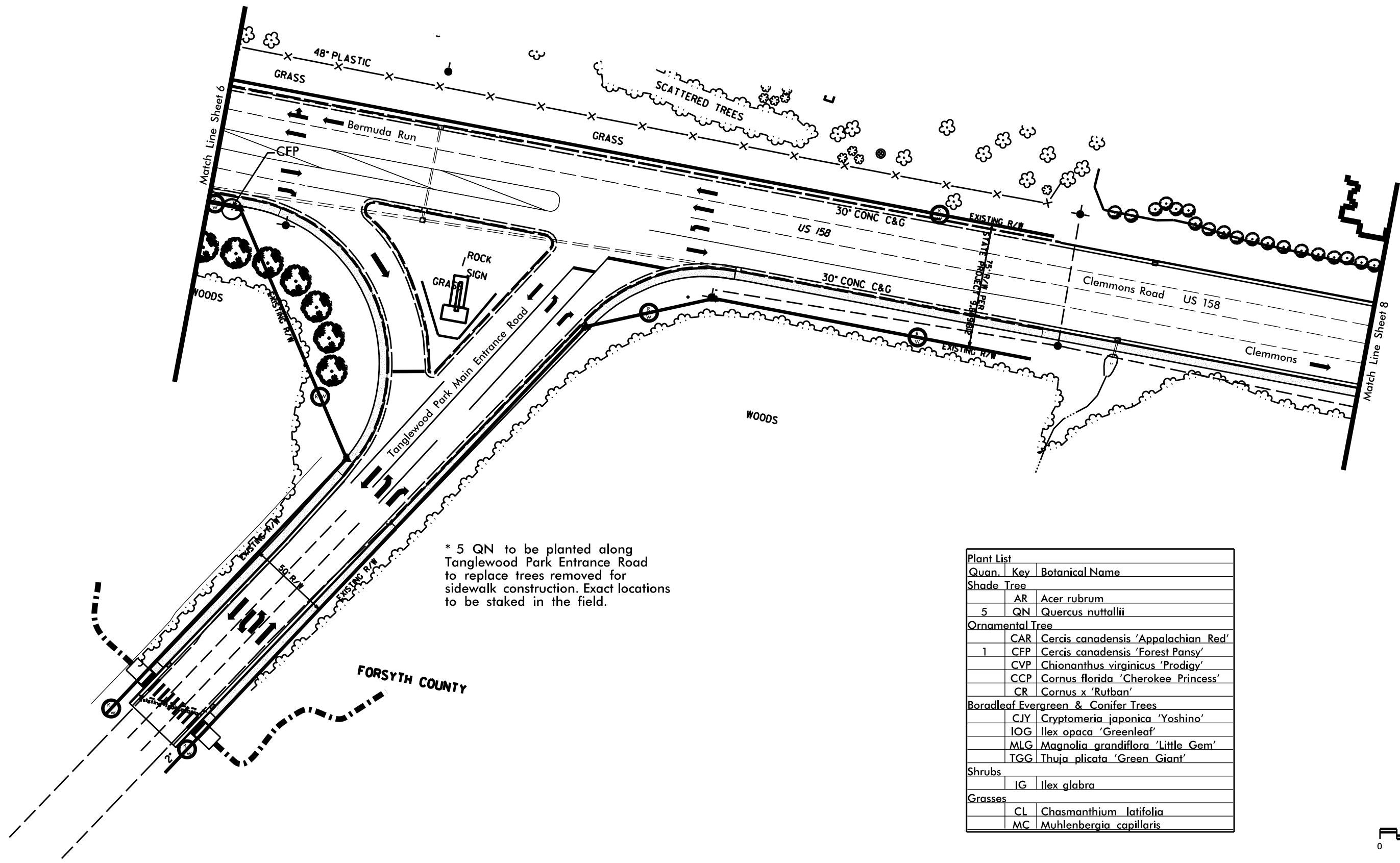

* 5 QN to be planted along Tanglewood Park Entrance Road to replace trees removed for sidewalk construction. Exact locations to be staked in the field.

Plant List		
Quan.	Key	Botanical Name
Shade Tree		
	AR	Acer rubrum
5	QN	Quercus nuttallii
Ornamental Tree		
	CAR	Cercis canadensis 'Appalachian Red'
1	CFP	Cercis canadensis 'Forest Pansy'
	CVP	Chionanthus virginicus 'Prodigy'
	CCP	Cornus florida 'Cherokee Princess'
	CR	Cornus x 'Rutban'
Broadleaf Evergreen & Conifer Trees		
	CJY	Cryptomeria japonica 'Yoshino'
	IOG	Ilex opaca 'Greenleaf'
	MLG	Magnolia grandiflora 'Little Gem'
	TGG	Thuja plicata 'Green Giant'
Shrubs		
	IG	Ilex glabra
Grasses		
	CL	Chasmanthium latifolia
	MC	Muhlenbergia capillaris

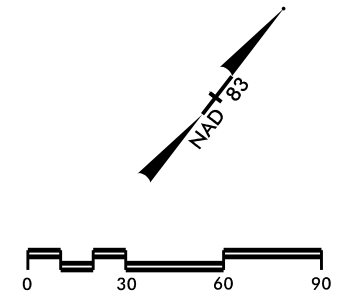

NCDOT - Roadside Environmental Unit
 Landscape Design & Development
 1557 Mail Service Center Raleigh NC 27699-1557
 ph: 919-707-2938
http://www.ncdot.org/doh/operations/dp_chief_eng/roadside/

US 158 (Clemmons Road) at the Yadkin River
 From Bermuda Run Country Club Entrance to Craver Land Road
 TIP #:

Connie Morgan
 REU Engineer

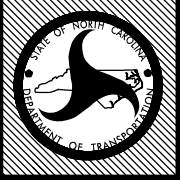

PREL. DESIGN DATE: June 8, 2012
 FINAL DESIGN DATE: July 27, 2012
 DIVISION & COUNTY:
 Division 9, Forsyth County

SHEET DESCRIPTION:
 Landscape Development
 Planting Plan

SHEET NO: 7
 TOTAL SHEET NO: 7